

# KPS3101/3102/3204

## 1, 2, 4- Serial port DIN-rail Serial Device Servers



### » Overview

KPS3101, KPS3102, KPS3204 Serial Device Server supports 1 or 2 Ethernet port and 1, 2, or 4 RS-232/422/485 ports, which provides serial-to-Ethernet connectivity for industrial applications. KPS3101, KPS3102, KPS3204 supports socket operation mode, including TCP Server, TCP Client and UDP. KPS3101, KPS3102, KPS3204 provides 12-48 VDC redundant power inputs. The top panel of the device has DIP switches, DIP switch can be achieved RS485 serial terminal matching resistor enable and disable, It can guarantee the stability and reliability of RS485 serial communication. KPS3101, KPS3102, KPS3204 can be widely applied in all kinds of applications in factory automation and industrial segments.

### » Key Features

- 1 or 2 Ethernet port and 1, 2, or 4 RS-232/422/485 ports
- Supports socket operation modes, including TCP Server, TCP Client and UDP
- Supports one-key recovery
- Build-in 2KV serial Isolation protection
- IP40 protection class
- Metal housing with wide temperature rating (-40 to +75°C)
- Certificates : UL61010, Class I Div 2, CE, FCC, RoHS

### » Product Specifications

#### >Technical Specification

**-Ethernet Interface**

Number of ports:

KPS3101/KPS3102: 1

KPS3204: 2

Speed: 10/100 Mbps, Auto MDI/MDIX

Connector: RJ45

Magnetic Isolation Protection: 1.5 kV (built-in)

**-Serial Interface**

Number of ports:

KPS3101: 1

KPS3102: 2

KPS3204: 4

Serial Standards: RS-232/422/485, software selectable

Connector: DB9 male

ESD Protection: 15 kV for all signals

Isolation Protection: 2 kV (build-in)

DIP-Switch: Enable/Disable 120Ω matching resistor for RS485

**-Serial Communication Parameters**

Data Bits: 5, 6, 7 or 8

Stop Bits: 1, 1.5 or 2

Parity: None, Even, Odd, Space, Mark

Flow Control: XON/XOFF, RTS/CTS, None

Baudrate: 300bps to 460.8kbps

**-Security**

Security Protocols : HTTPS, SSH2

**-LED**

System: PWR1, PWR2, Run

Serial port: S1-T/R, S2-T/R, S3-T/R, S4-T/R

LAN: SPEED, ACT/LINK (RJ45)

**-Button**

Reset: Supports "reset to factory default settings"

### **-Power Requirements**

Input voltage : 12 to 48 VDC, recommended 24 VDC

Power plug: 4-pin terminal block

Power Consumption:

KPS3101/3102: 1.8W

KPS3204: 3.2W

Overload protection: Support

Reverse protection: Support

Redundancy protection: Support

### **-Physical Characteristics**

Housing: Aluminum

Weight:

KPS3101: 165g

KPS3102: 170g

KPS3204: 320g

Dimension:

KPS3101/KPS3102: 30×115×68 mm ( W×H×D )

KPS3204: 54×134×106 mm ( W×H×D )

Protection level: IP40

Installation: DIN-rail mounting

### **-Environmental Limits**

Operating temperature: -40 to 75°C

Storage temperature: -40 to 85°C

Operating humidity: 5 to 95% RH

### **-Quality Assurance**

Warranty: 5 years

### **-Approvals**

UL61010, Class I Div 2, CE, FCC, RoHS

IEC 60950-1, EN 60950-1

**-Industrial Standard**

EMI:

EN 55032

FCC Part 15 Subpart B Class A

EMS:

EN 55024

IEC61000-4-2(ESD):  $\pm 6\text{kV}$ (contact),  $\pm 8\text{kV}$ (air)

IEC 61000-4-3(RS): 10V/m (80MHz–2GHz,)

IEC61000-4-4(EFT): Power Port: $\pm 2\text{kV}$ ;Data Port: $\pm 1\text{kV}$

IEC61000-4-5(Surge): PowerPort:  $\pm 1\text{kV/DM}$ ,  $\pm 2\text{kV/CM}$ ; Data Port: $\pm 1\text{kV}$

IEC 61000-4-6(CS): 10V(150KHz-80MHz)

Machinery:

IEC60068-2-6(Vibration)

IEC60068-2-27(Shock)

IEC60068-2-32(Free Fall)

**» Mechanical Drawing**

**KPS3101**

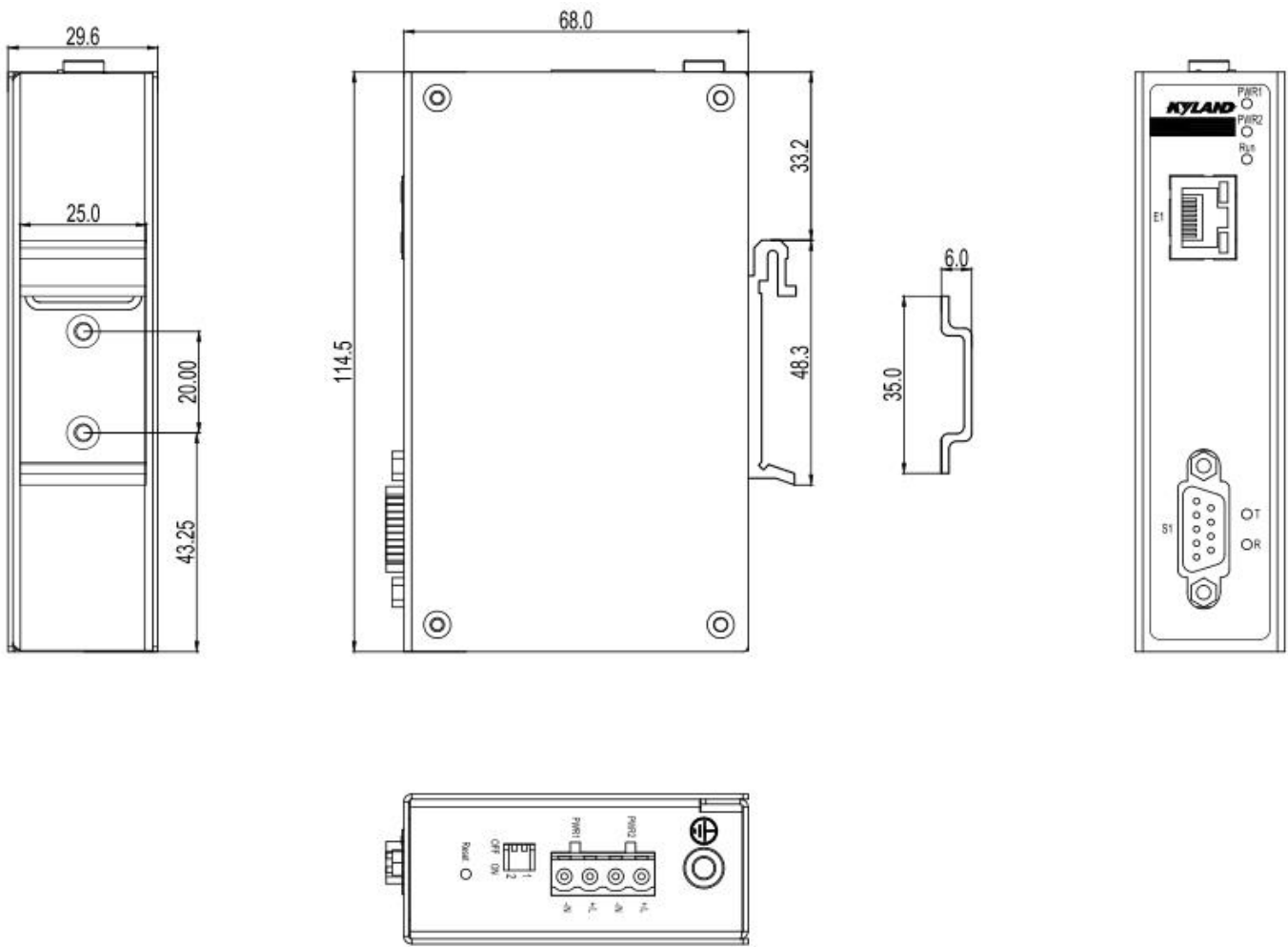

KPS3102

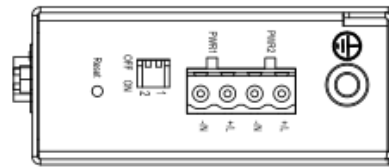
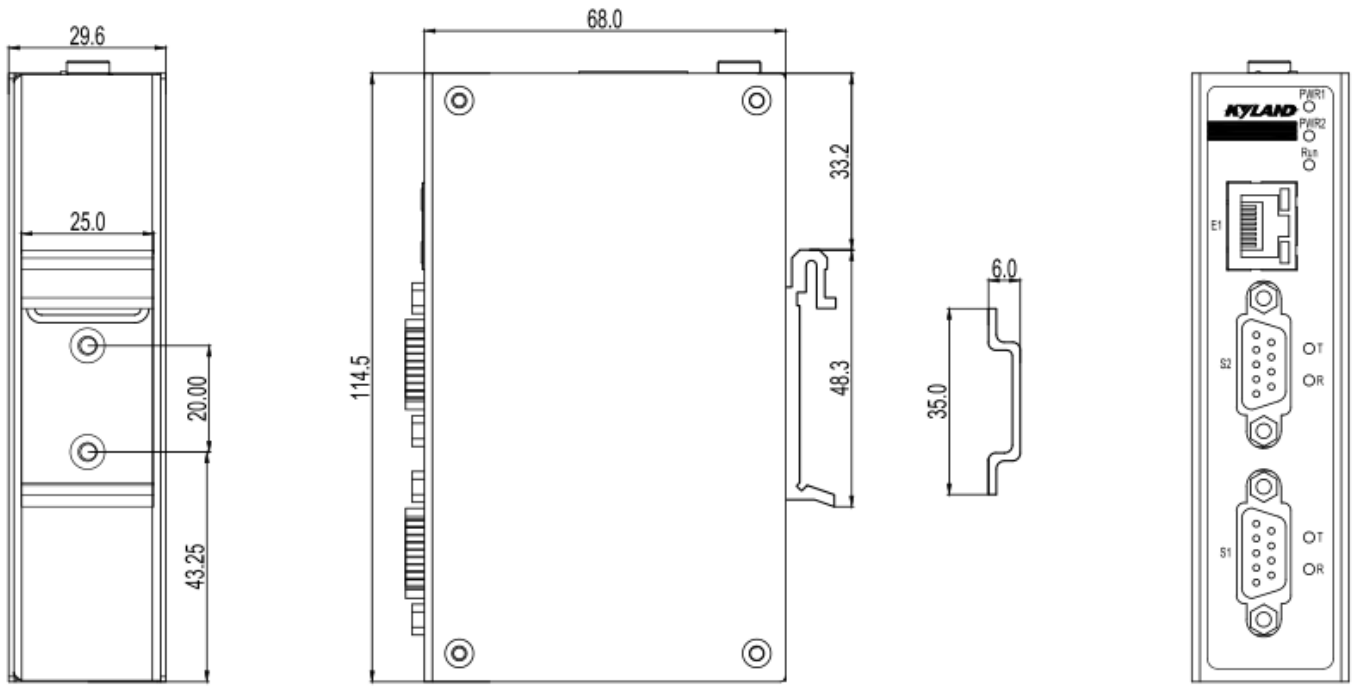

**KPS3204**

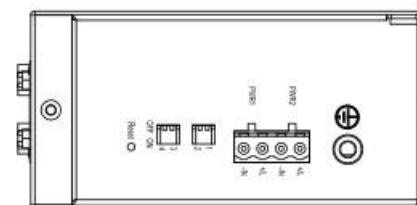
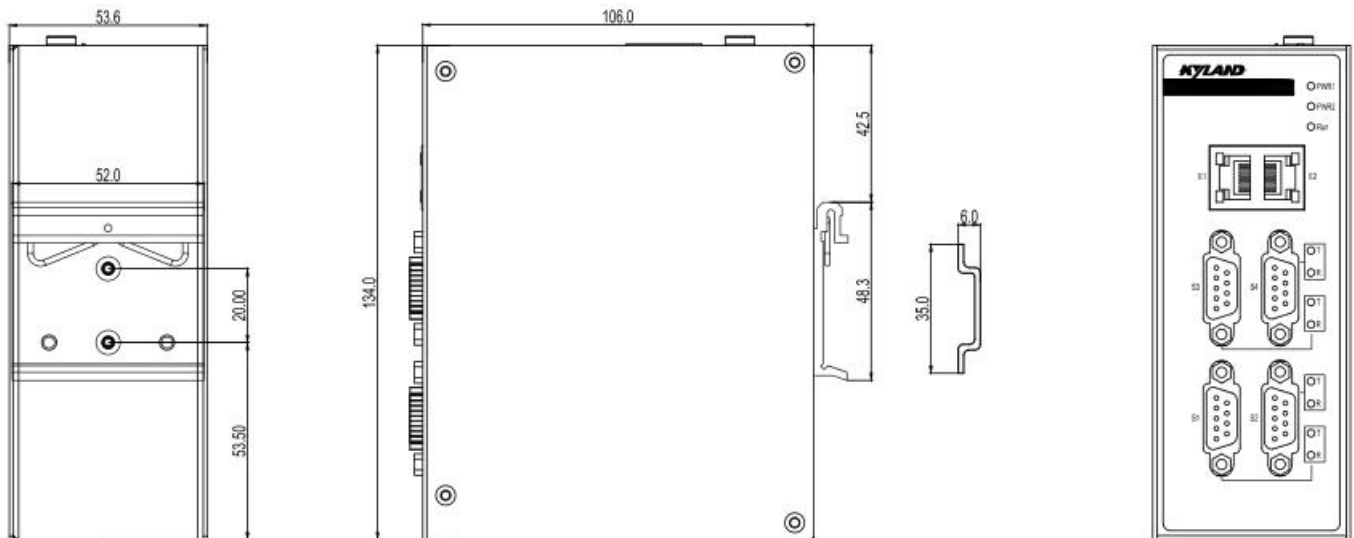

**»» Ordering Information**

**Available Models**

**KPS3101-1T1D-L17-L17: 1-port Serial Device Servers**

**KPS3102-1T2D-L17-L17: 2-port Serial Device Servers**

**KPS3204-2T4D-L17-L17: 4-port Serial Device Servers**

Version:2020-10-30 09:47:01